

ASIAN FORESTRY COMPANY (SABAH) SDN. BHD.

Block L-70-7, 7th Floor, KK Times Square, Off Coastal Highway, 88810 Kota
Kinabalu, Sabah
Tel: 088 – 486 242 Fax: 088 – 486 241



ENVIRONMENTAL COMPLIANCE REPORT

For

**Proposed Salvage Logging and Industrial Tree Plantation
(ITP) [11,191 hectares] within Paitan Forest Reserve under
Forest Management Unit (FMU) No. 2, Labuk Sugut,
Beluran District, Sabah**

2ND REPORT OF YEAR 2023

NOVEMBER 2022 - FEBRUARY 2023	MARCH 2023 - JUNE 2023	JULY 2023 – OCTOBER 2023
	√	

AEC Ref. No. : JPAS/PP/BLN/600 – 1/01/3/70
Report Reference : CK/MO411/1445–2/23
Date of Report : 20th July 2023



**CHEMSAIN
KONSULTANT
SDN BHD** (130904-U)

TABLE OF CONTENTS

CONTENTS	PAGE
1.0 INTRODUCTION	2
1.1 Monitoring Information	2
1.2 Project Proponent Information	2
1.3 Post – EIA Consultant Information	3
1.4 Other Approvals	3
1.5 Project Status	3
2.0 LEGAL REQUIREMENT	3
3.0 CHANGES TO PROJECT CONCEPT / ENVIRONMENT	4
3.1 Changes in Project Concept	4
3.2 Changes in Surrounding Environment.....	4
4.0 MONITORING LOCATION	5
5.0 COMPLIANCE STATUS, OBSERVATION, CORRECTIVE ACTION & DATE OF COMPLETION	8
6.0 CONCLUSION	19
6.1 Overall Compliance for March – June 2023	19

LIST OF TABLES

Table 1.0: Chronology of events	3
Table 2.0: Changes in project concept	4
Table 3.0: Changes in surrounding environment.....	4
Table 4.0: Environmental monitoring and sampling particulars.....	5

LIST OF FIGURES

Figure 1.0: Project Site Location (Extra Extracted from EIA Report).....	6
Figure 2.0: Mitigation, monitoring locations (<i>Extracted from EIA Report</i>) and plates	7

LIST OF APPENDICES

Appendix A:	Plates
Appendix B:	Environmental Monitoring Report
Appendix C:	i. Surface Water Test Reports ii. National Water Quality Standard for Malaysia (NWQSM)
Appendix D:	Other Officials Approvals

ASIAN FORESTRY COMPANY (SABAH) SDN. BHD.

ENVIRONMENTAL COMPLIANCE REPORT

1.0 INTRODUCTION

The Project involves forestry development and operations over an area of 11,191 hectares, comprising of 30 compartments in total – CPT01 to CPT30, located in part of the Paitan Forest Reserve in the District of Labuk Sugut, Beluran.

The project site is approximately 8 km north of Paitan township. The western part of the project site (CPT24 to CPT30) can be accessed from Jalan Sapi Nangoh, turning into an existing unsealed estate road (known as Lembah Paitan Estate of Boustead Rimba Nilai Sdn. Bhd.), while the eastern part of the project site (CPT07 to CPT09) is accessible via the asphalt road of Jalan Sapi-Nangoh.

1.1 Monitoring Information

Project Name:	: Proposed Salvage Logging and Industrial Tree Plantation (ITP) [11,191 hectares] within Paitan Forest Reserve under Forest Management Unit (FMU) No. 2, Labuk Sugut, Beluran District, Sabah.
EIA Letter Reference No.	: JPAS/PP/BLN/600-1/01/3/70(29) dated 27 th September 2021
Monitoring Period	: March – June 2023
Date of Monitoring	: Compliance Audit Visit : 26 th June 2023 Surface Water Sampling : 26 th June 2023
EIA Consultant	: Chemsain Konsultant Sdn. Bhd.

1.2 Project Proponent Information

Project Proponent	: Asian Forestry Company (Sabah) Sdn. Bhd.
Contact Person	: Mr. Thondik Venantius
Tel. No.	: 088 – 663494
Fax No.	: 088 – 662494
Environmental Officer	: Ms. Wilvia Olivia William
Email	: w.william@forestsolutions.com.my
Contact No	: 019 – 822 6958

1.3 Post – EIA Consultant Information

Post – EIA Consultant : Chemsain Konsultant Sdn. Bhd.
Tel. No. : Office : 088 – 381 277 / 278
 Mobile : 019 – 812 0808
Fax No. : 088 – 381 280
Contact Person : Jessica Malagkas / Vianah Boman
Designation : ESH Consultant / Section Head
Email : Jessica.malagkas@chemsain.com/vianah.boman@chemsain.com

1.4 Other Approvals

Development Plan Ref. : Nil
 Earthwork Plan Ref. : Nil
 Drainage Plan Ref. : Nil
 ESCP Ref. : Nil

1.5 Project Status

Project Completion : Total planted area : 618.7 ha
 Total harvested area : 133.7 ha

**Project progress status as of 30/06/2023*

***It shall be noted that logging progress is subject to change.*

Chronology of Events :

Table 1.0: Chronology of events

No	Event	Date
1.	Signing of AEC Ref. No.: JPAS/PP/BLN/600-1/01/3/70	21 th September 2021

2.0 LEGAL REQUIREMENT

The industrial tree plantation is classified as a prescribed activity under the **Second Schedule** of the **Environment Protection Enactment (Prescribed Activities) (Environmental Impact Assessment) Order 2005**, under Items **2 (i)** and **2 (ii)**:

(2) FORESTRY

- (i). *Felling or extraction of timber covering an area of 500 hectares or more; or*
- (ii). *Development of forest plantation or reforestation covering an area of 500 hectares or more.*

Under this Order, Environmental Compliance Report (ECR) is to be carried out **once in every four (4) months**, and reported in accordance with the Approval Conditions as specified in the **Syarat-Syarat Alam Sekitar (Peruntukan Seksyen 12E (1), Enakmen Perlindungan Alam Sekitar 2002)**, ref: JPAS/PP/BLN/600-1/01/3/70 dated 21th September 2021.

3.0 CHANGES TO PROJECT CONCEPT / ENVIRONMENT

3.1 Changes in Project Concept

Table 2.0: Changes in project concept

No.	Item	Changes
1.	Project Component	Nil
2.	Changes to Land Lot	Nil
3.	Land Area	Nil

3.2 Changes in Surrounding Environment

Table 3.0: Changes in surrounding environment

No.	Item	Changes
1.	Project Component	Nil
2.	Changes to Land Lot	Nil
3.	Land Area	Nil

4.0 MONITORING LOCATION

Designated sampling locations are shown in **Figure 1.0** and **Figure 2.0** with details summarised in **Table 4.0**.

Table 4.0: Environmental monitoring and sampling particulars

Component	Key	GPS Coordinates Datum: Timbalai	Description
*Surface Water	W1	N 06° 22' 38.47" E 117° 23' 21.01"	Tributary of an unnamed stream
	W2	N 06° 20' 51.46" E 117° 21' 21.00"	Sg. Kawananan
	W3	N 06° 24' 18.10" E 117° 14' 33.87"	Tributary of Sg. Paitan
	W4	N 06° 27' 13.05" E 117° 11' 55.83"	Tributary of Sg. Paitan
	W5	N 06° 28' 53.03" E 117° 09' 45.78"	Sg. Paitan
	W6	N 06° 21' 59.33" E 117° 27' 38.59"	Tributary of an unnamed stream

Note: * Water sampling is carried out at the relevant monitoring locations with respect to the current Project- progress-development

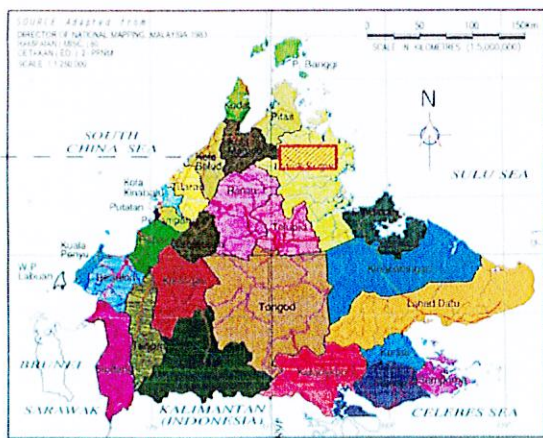

- Legend:**
- Project Site Boundary
 - Base Camp Area
 - W1-W6 Water Sampling Points
 - Paitan Forest Reserve
 - Lingkabau Forest Reserve
 - Sugut Forest Reserve
 - Compartment Boundary
 - Main Road
 - Unsealed Road
 - CPT01-CPT30 Compartments

Points	Coordinates
0A	N 6° 10' 33.93" E 117° 10' 07.65"
0B	N 6° 27' 46.97" E 117° 12' 16.25"
0C	N 6° 21' 59.79" E 117° 18' 59.20"
0D	N 5° 24' 10.13" E 117° 27' 51.92"
0E	N 6° 22' 23.49" E 117° 29' 23.46"
0F	N 6° 19' 09.57" E 117° 20' 09.67"
0G	N 6° 21' 55.35" E 117° 16' 08.36"
0H	N 6° 27' 02.04" E 117° 9' 26.82"

ENVIRONMENTAL IMPACT ASSESSMENT
 Proposed Salvage Logging and Industrial Tree Plantation (ITP) (11,191 Hectares) within Paitan Forest Reserve under Forest Management Unit (FMU) No. 2, Labuk Sugut, Beluran District, Sabah.
 By Asian Forestry Company (Sabah) Sdn Bhd



Project Site Location, Baseline Sampling Points and Surrounding Land Use

Figure: 1

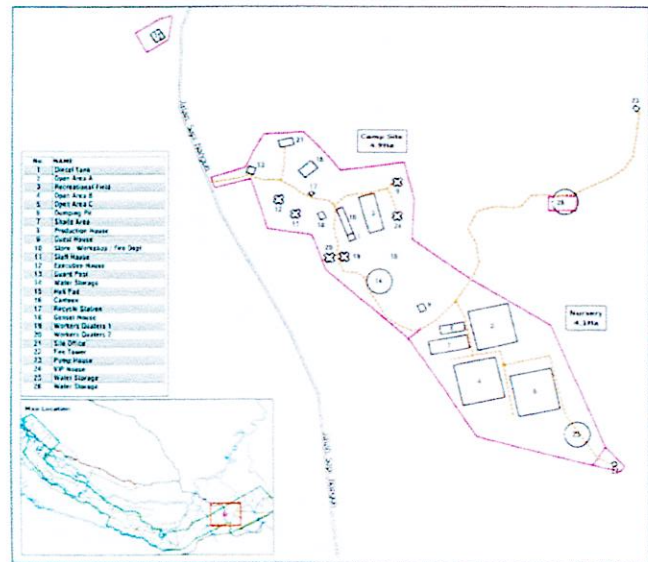
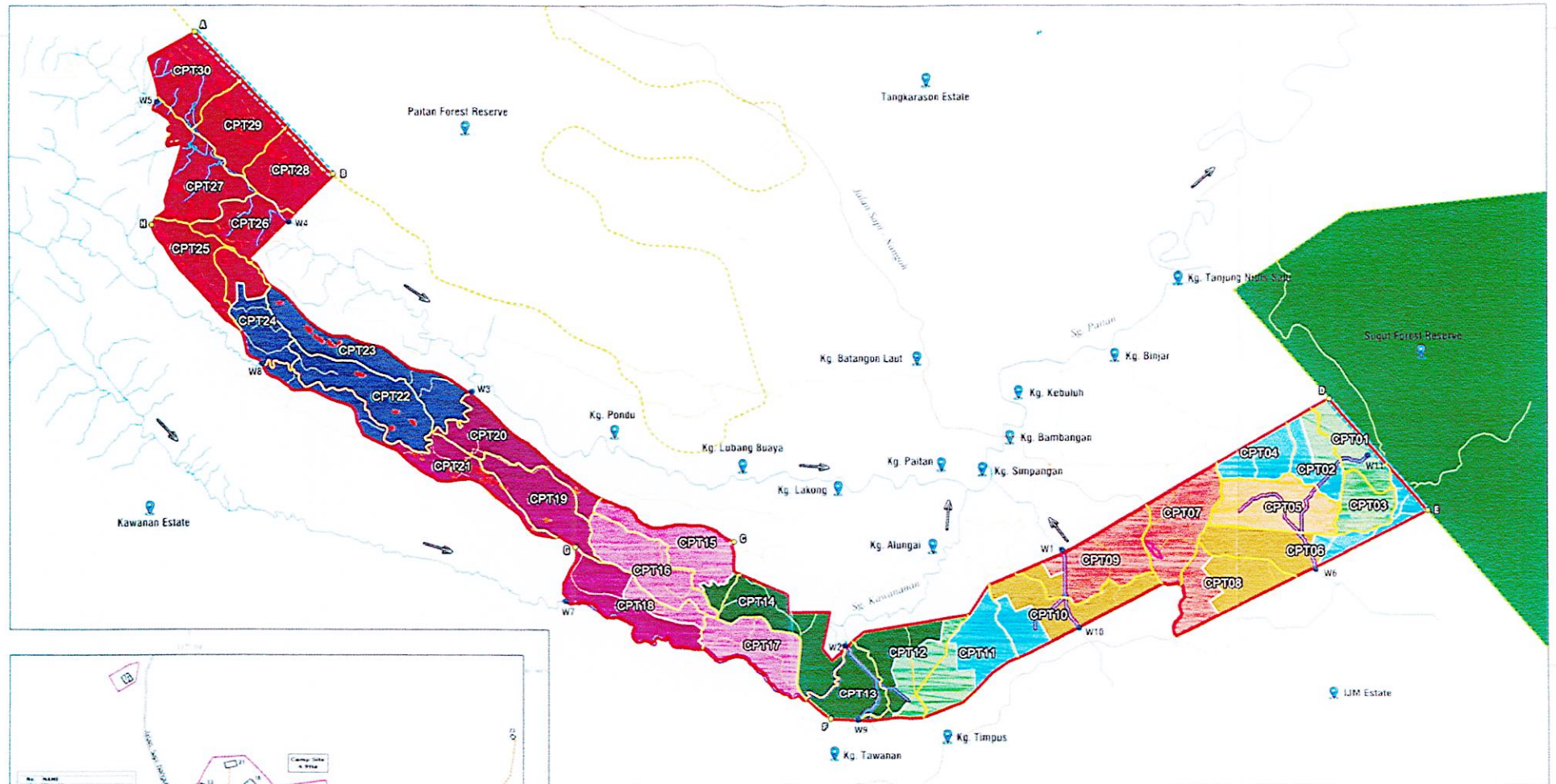

Legend:

- Project Site Boundary
- Base Camp Area
- Paitan Forest Reserve
- Sugut Forest Reserve
- Compartment Boundary
- River
- Main Road
- Unsealed Road
- Forest Reserve Buffer Zone (50m)
- Slope ≥ 25
- W1-W5 Proposed Water Monitoring Locations
- Proposed Riparian Reserve
- Flow Direction

Replanting Programme

Block	Year	Area	Points	Coordinates	Points	Coordinates
A	2021	487 Ha	● A	N 8° 30' 03.09" E 117° 10' 07.55"	● W1	N 8° 21' 49.30" E 117° 23' 40.35"
B	2022	948 Ha	● B	N 8° 27' 48.97" E 117° 12' 18.25"	● W2	N 8° 20' 20.78" E 117° 20' 15.31"
C	2023	948 Ha	● C	N 8° 21' 59.79" E 117° 18' 30.20"	● W3	N 8° 24' 22.30" E 117° 14' 23.64"
D	2024	948 Ha	● D	N 8° 24' 10.13" E 117° 27' 51.02"	● W4	N 8° 27' 03.78" E 117° 11' 34.26"
E	2025	948 Ha	● E	N 8° 27' 23.49" E 117° 29' 23.46"	● W5	N 8° 28' 56.33" E 117° 09' 32.32"
F	2026	948 Ha	● F	N 8° 18' 09.53" E 117° 20' 00.82"	● W6	N 8° 21' 29.34" E 117° 27' 37.63"
G	2027	948 Ha	● G	N 8° 21' 55.35" E 117° 16' 00.38"	● W7	N 8° 21' 05.21" E 117° 15' 51.44"
H	2028	948 Ha	● H	N 8° 27' 02.04" E 117° 9' 28.02"	● W8	N 8° 24' 50.62" E 117° 11' 08.48"
	2029	948 Ha			● W9	N 8° 19' 08.02" E 117° 20' 26.51"
	2030	948 Ha			● W10	N 8° 20' 35.31" E 117° 23' 58.31"
					● W11	N 8° 23' 16.16" E 117° 28' 27.43"

Riparian Reserve Requirements

Width of River / Tributary (m)	Riparian Reserve Width (m)
$\geq 3m$	50m
$< 3m$	30m

ENVIRONMENTAL IMPACT ASSESSMENT
 Proposed Salvage Logging and Industrial Tree Plantation (ITP) (11,191 Hectares) within Paitan Forest Reserve under Forest Management Unit (FMU) No. 2, Lubas Sugut, Bahran District, Sabah
 By Asian Forestry Company (Sabah) Sdn. Bhd.



Proposed Mitigation Measures and Monitoring Locations

5.0 COMPLIANCE STATUS, OBSERVATION, CORRECTIVE ACTION & DATE OF COMPLETION

Nama Projek	: Proposed Salvage Logging and Industrial Tree Plantation (ITP) [11,191 hectares] within Paitan Forest Reserve under Forest Management Unit (FMU) No. 2, Labuk Sugut, Beluran District, Sabah.
Nama Pemaju	: Asian Forestry Company (Sabah) Sdn. Bhd.
Rujukan fail jabatan ini	: JPAS/PP/BLN/600-1/01/3/70
Tarikh Akujanji	: 27 th September 2021
Penyedia laporan pematuhan ini	: Chemsain Konsultant Sdn. Bhd.
Tempoh diliputi oleh laporan ini	: March – June 2023

AEC No.	Approved Environmental Conditions (AEC)	Status	Observation / Comment	Photo No.	Corrective Action & Date of Completion
5.1	<u>Hakisan Tanah Dan Pemendapan Kelodak</u>				
5.1.1	<u>Kawalan Kawasan Pembangunan</u>				
<i>i</i>	<i>Satu (1) salinan pelan pengukuran sempadan kawasan projek sebagaimana ditunjukkan pada "Figure: 1" dan Figure: 2" dalam Perjanjian Syarat-syarat Alam Sekitar ini hendaklah dikemukakan ke JPAS sebelum aktiviti pembersihan dan perladangan hutan dimulakan.</i>	Comply	The Project boundary survey work previously carried out is attached as Appendix D .	-	-
<i>ii</i>	<i>Sempadan kawasan projek hendaklah ditanda di lapangan serta dipasang dengan papan tanda di lokasi-lokasi yang mudah dilihat sebelum aktiviti pembersihan dan perladangan hutan dimulakan.</i>	Comply	<ul style="list-style-type: none"> ▪ Signage and red-painted wooden pegs in place demarcating Project boundary (i.e. Paitan Forest Reserve boundary). ▪ Signage and a security guard house sighted in place at the entrance to the base camp at CPT07 during the visit. 	1 to 5	-

AEC No.	Approved Environmental Conditions (AEC)	Status	Observation / Comment	Photo No.	Corrective Action & Date of Completion
			<ul style="list-style-type: none"> According to the Project Proponent, these Project blocks and compartments are separated by access roads. 		
iii	<i>Semua tanda sempadan tapak projek hendaklah tidak ditimbus, dihalang, dirosakkan atau diganggu daripada kedudukan asal.</i>	Comply	Signage and pegs demarcating project boundary easily sighted and in good condition.	1 to 5	-
iv	Zon penampian dengan kelebaran tidak kurang 50 meter hendaklah disediakan di sempadan kawasan projek yang bersempadan dengan Hutan Simpan Sugut (Kelas I) yang ditandakan sebagai garis DE dan Hutan Simpan Paitan (Kelas II) yang ditandakan sebagai garis AB pada "Figure: 2" dalam Perjanjian Syarat-syarat Alam Sekitar ni.	Not Applicable	According to the Project Proponent, boundaries marked DE and AB as shown in Figure 2.0 were yet to be physically explored and created access to, due to project progress is currently confined within CPT05 and CPT07 - CPT10.	-	-
v	Sebarang aktiviti pembalakan dan perladangan hutan tidak dibenarkan dalam kawasan zon penampian.	Comply	Refer to the comment in AEC No. 5.1.1. (iv)	-	-
vi	Sebarang aktiviti pembalakkan dan perladangan hutan tidak dibenarkan dalam kawasan berkecerunan 25 darjah atau lebih sebagaimana ditunjukkan pada "Figure: 2" dalam Perjanjian Syarat-syarat Alam Sekitar ini.	Not Applicable	ITP development activities currently confined to CPT05 and CPT07 – CPT10, where there are no slopes with gradient of 25° or more.	-	-

AEC No.	Approved Environmental Conditions (AEC)	Status	Observation / Comment	Photo No.	Corrective Action & Date of Completion
vii	Sempadan kawasan zon penampungan dan kawasan berkecerunan 25 darjah atau lebih hendaklah ditandai di lapangan dan dipasang dengan papan tanda di lokasi-lokasi yang mudah dilihat sebelum aktiviti pembalakan dan perladangan hutan dimulakan.	Not Applicable	Refer to the comment in AEC No. 5.1.1. (vi)	-	-
viii	Sebarang aktiviti pembalakan dan perladangan hutan tidak dibenarkan di luar sempadan tapak projek.	Comply	ITP development activities outside of the project boundary was not sighted.	-	-
5.1.2	<u>Kawalan Pembinaan Jalan</u>				
i	Pembinaan jalan hendaklah dikawal dengan meminimalkan aktiviti kerja tanah.	Comply	Earthwork for road construction sighted within the project site was minimised as assured by the Project Proponent.	6 - 8	-
ii	Jalan sedia ada hendaklah digunakan bagi mengurangkan gangguan terhadap tanah.	Comply	All existing access roads were fully utilised as observed during the visit.	6 - 8	-
iii	Sistem perparitan hendaklah disediakan bagi mengalirkan air keluar dari struktur jalan dan dilencongkan ke kawasan yang mempunyai tumbuhan.	Comply	Roadside earth drainage sighted diverted towards vegetated areas.	6	-
iv	Aktiviti pelupusan atau pembuangan bahan tanah berlebihan tidak dibenarkan dalam sungai atau alur air.	Comply	Disposal of overburden into nearest natural waterways was not sighted during the site visit.	-	-

AEC No.	Approved Environmental Conditions (AEC)	Status	Observation / Comment	Photo No.	Corrective Action & Date of Completion
5.1.3	<u>Pembinaan Rumah Pekerja, Kem Pekerja atau Bengkel dan Tapak Semaian</u>				
i	Sebarang aktiviti kerja tanah dan pembersihan kawasan untuk tujuan pembinaan rumah pekerja, kem pekerja, bengkel atau tapak semaian hendaklah diminimalkan.	Comply	<ul style="list-style-type: none"> ▪ Nursery sighted under construction during the visit. ▪ Temporary workers' camp sighted in place during the visit. Construction of the new workers' quarters has attained completion. 	9, 10	-
ii	Sistem perparitan yang berkesan hendaklah disediakan bagi mengawal larian air permukaan dan air buangan dari kawasan rumah pekerja, kem pekerja, bengkel atau tapak semaian dan hendaklah dilencongkan ke kawasan yang mempunyai tumbuhan dan tidak dibenarkan dialir terus ke dalam sungai atau alur air.	Comply	Surface runoff near the temporary worker's campsite diverted towards vegetated areas.	6	-
iii	Kedudukan rumah pekerja atau kem pekerja hendaklah terletak di luar kawasan simpanan sungai yang dinyatakan pada syarat 5.2(1) dalam Perjanjian Syarat-syarat Alam Sekitar ini.	Comply	The new workers' quarters and workers' campsite within the base camp at CPT07 sighted located outside of the riparian reserve.	9	-
iv	Kedudukan bengkel atau tapak semaian hendaklah terletak tidak kurang 50 meter pada jarak mendatar dari tebing sungai atau alur air.	Not Applicable	Refer to the comments in AEC No. 5.1.3 (i) .	-	-
v	Semua rumah pekerja, kem pekerja, bengkel atau tapak semaian sedia ada yang tidak mematuhi peraturan-peraturan yang dinyatakan dalam Perjanjian Syarat-syarat Alam Sekitar ini hendaklah dipindahkan dan	Comply	<ul style="list-style-type: none"> • Refer to the comments in AEC No. 5.1.3 (i). • Siting of all facilities are in compliance with the AEC. 	-	-

AEC No.	Approved Environmental Conditions (AEC)	Status	Observation / Comment	Photo No.	Corrective Action & Date of Completion
	<i>dikawal sebagaimana ditetapkan.</i>				
5.1.4	<u>Rehabilitasi Tanah Yang Terdedah</u>				
<i>i</i>	<i>Semua kawasan yang terdedah hendaklah dilindungi dengan menanam spesies tumbuhan yang diluluskan oleh Jabatan Perhutanan Negeri Sabah.</i>	Comply	<ul style="list-style-type: none"> Exposed grounds within plantation area sighted covered with vegetation to cater for soil erosion. Existing vegetation within inactive Project areas were retained and remain undisturbed to reduce soil erosion. 	13-16	-
5.1.5	<u>Pembangunan Berfasa/ Berperingkat</u>				
<i>i</i>	<i>Aktiviti pembalakan dan perladangan hutan hendaklah dilaksanakan secara berfasa sebagaimana ditunjukkan pada "Figure: 2" dalam Perjanjian Syarat-syarat Alam Sekitar ini bagi mengawal kesan hakisan tanah dan pendedahan kelodak.</i>		According to the Project Proponent, project development was carried out in phases with respect to compartments and blocks as per Figure 2.0 .	12 to 16	
<i>ii</i>	<i>Pelan aktiviti pembalakan dan perladangan hutan secara berfasa hendaklah disediakan dengan mengambikira kawalan kesan aktiviti projek kepada persekitaran.</i>		<ul style="list-style-type: none"> Refer to the comments in AEC No. 5.1.5 (i). The Project Proponent duly noted and assures to adhere to this condition. 	12 to 16	

AEC No.	Approved Environmental Conditions (AEC)	Status	Observation / Comment	Photo No.	Corrective Action & Date of Completion						
5.2	<u>Perlindungan Sungai</u>										
i	<p><i>Simpanan sungai berikut hendaklah dilindungi dan ditanda di lapangan:</i></p> <table border="1" data-bbox="248 428 750 1138"> <thead> <tr> <th data-bbox="248 428 501 511">Sungai</th> <th data-bbox="501 428 750 511">Simpanan Sungai</th> </tr> </thead> <tbody> <tr> <td data-bbox="248 511 501 863"> <p><i>Sungai Paitan, Sungai Kawananan serta semua sungai dalam kawasan projek yang mempunyai kelebaran 5 meter atau lebih.</i></p> </td> <td data-bbox="501 511 750 863"> <p><i>Sekurang-kurangnya selebar 50 meter pada jarak mendatar dari tebing sungai.</i></p> </td> </tr> <tr> <td data-bbox="248 863 501 1138"> <p><i>Semua anak sungai dalam kawasan projek yang mempunyai kelebaran kurang daripada 5 meter.</i></p> </td> <td data-bbox="501 863 750 1138"> <p><i>Sekurang-kurangnya selebar 30 meter pada jarak mendatar dari tebing sungai.</i></p> </td> </tr> </tbody> </table>	Sungai	Simpanan Sungai	<p><i>Sungai Paitan, Sungai Kawananan serta semua sungai dalam kawasan projek yang mempunyai kelebaran 5 meter atau lebih.</i></p>	<p><i>Sekurang-kurangnya selebar 50 meter pada jarak mendatar dari tebing sungai.</i></p>	<p><i>Semua anak sungai dalam kawasan projek yang mempunyai kelebaran kurang daripada 5 meter.</i></p>	<p><i>Sekurang-kurangnya selebar 30 meter pada jarak mendatar dari tebing sungai.</i></p>	Comply	<ul style="list-style-type: none"> • Water reservoir area sighted provided with riparian reserve signage at CPT07. • Riparian reserve for tributary stream sighted demarcated with "Buffer zone" signage and wooden blue pegs during the visit. 	19 - 22	-
Sungai	Simpanan Sungai										
<p><i>Sungai Paitan, Sungai Kawananan serta semua sungai dalam kawasan projek yang mempunyai kelebaran 5 meter atau lebih.</i></p>	<p><i>Sekurang-kurangnya selebar 50 meter pada jarak mendatar dari tebing sungai.</i></p>										
<p><i>Semua anak sungai dalam kawasan projek yang mempunyai kelebaran kurang daripada 5 meter.</i></p>	<p><i>Sekurang-kurangnya selebar 30 meter pada jarak mendatar dari tebing sungai.</i></p>										
ii	<p><i>Sebarang aktiviti pembersihan, pembalakan serta perladangan hutan adalah tidak dibenarkan dalam simpanan sungai.</i></p>	Comply	ITP development within the riparian reserves was not sighted during the site visit at CPT07, CPT05 and CPT06.	19 - 22							
iii	<p><i>Sempadan simpanan sungai hendaklah ditanda di lapangan dengan cat merah serta dipasang</i></p>	Comply	Refer to the comment in AEC No. 5.2. (i) .	19 - 22							

AEC No.	Approved Environmental Conditions (AEC)	Status	Observation / Comment	Photo No.	Corrective Action & Date of Completion				
	dengan papan tanda di lokasi-lokasi yang mudah dilihat sebelum aktiviti pembalakan dan perladangan hutan dimulakan.								
iv	Sebarang pembinaan rumah pekerja, kem pekerja, bengkel, tandas atau struktur bangunan lain tidak dibenarkan dalam simpanan sungai.	Comply	Construction of structures within the riparian reserves was not sighted during the site visit.	-					
v	Sebarang penyimpanan bahan minyak atau bahan toksik tidak dibenarkan dalam simpanan sungai.	Comply	Storage of oil and toxic material within riparian reserves was not sighted during the site visit.	-					
vi	Sebarang bahan tanah berlebihan, sisa pepejal, sisa biomas, kumbahan, bahan minyak, kimia atau bahan toksik tidak dibenarkan dilupuskan dalam simpanan sungai.	Comply	Disposal of overburden or any types of wastes (i.e. vegetative wastes, solid wastes, sewage, toxic wastes, etc.) within riparian reserves or any nearest natural waterways was not sighted during the site visit.	-					
5.2.1.2	<p>Laporan pemantauan kualiti air juga hendaklah dikemukakan ke JPAS bersama dengan laporan pematuhan tersebut.</p> <p>Lokasi dan parameter yang perlu dianalisa adalah seperti berikut:</p> <table border="1" data-bbox="241 1110 734 1356"> <thead> <tr> <th>Lokasi</th> <th>Parameter</th> </tr> </thead> <tbody> <tr> <td>Sebagaimana ditunjukkan pada "Figure: 2" dalam Perjanjian Syarat-syarat Alam Sekitar ini.</td> <td>Turbidity, Total Suspended Solid, Oil & Grease, Total Coliform Count.</td> </tr> </tbody> </table>	Lokasi	Parameter	Sebagaimana ditunjukkan pada "Figure: 2" dalam Perjanjian Syarat-syarat Alam Sekitar ini.	Turbidity, Total Suspended Solid, Oil & Grease, Total Coliform Count.	Comply	<ul style="list-style-type: none"> Surface water sampling was not carried out for W6 as per Figure 2.0, as sampling location was flooded during the visit. No water sampling carried out at locations W1 – W5 as Project development had yet to progress to said sampling locations. 	23	
Lokasi	Parameter								
Sebagaimana ditunjukkan pada "Figure: 2" dalam Perjanjian Syarat-syarat Alam Sekitar ini.	Turbidity, Total Suspended Solid, Oil & Grease, Total Coliform Count.								

AEC No.	Approved Environmental Conditions (AEC)	Status	Observation / Comment	Photo No.	Corrective Action & Date of Completion
5.3	<u>Perlindungan Habitat Hidupan Liar</u>				
i	Langkah kawalan bagi tujuan perlindungan hidupan liar dan habitatnya hendaklah dirujuk dengan Jabatan Hidupan Liar (JHL).	Comply	<ul style="list-style-type: none"> The letter to Wildlife Dept. (JHL), notifying ITP's commencement date as well as control measures done at CPT05 has been submitted by the Project Proponent as attached in Appendix D. Signage prohibiting hunting sighted at strategic places within the project site. 	28-29	
ii	Salinan surat pemakluman kepada JHL mengenai tarikh aktiviti pembalakan dan perladangan hutan dimulakan sebagaimana ketetapan jabatan berkenaan hendaklah dikemukakan ke JPAS.	Comply	Refer to the comment in AEC No. 5.3. (i) .	-	
5.4	<u>Bahan Minyak dan Sisa Toksik</u>				
i	Bahan minyak dan sisa toksik adalah tidak dibenarkan dilupuskan atau dibiarkan mengalir ke dalam sungai atau alur air.	Comply	Disposal of any oil and toxic material into the nearest natural waterways was not sighted during the site visit.	-	-
ii	Bahan minyak dan sisa toksik hendaklah dikumpul dan disimpan dalam bekas yang kukuh dan tidak mudah bocor. Bekas-bekas penyimpanan tersebut hendaklah dilabel.	Comply	<ul style="list-style-type: none"> New storage for agro-chemicals and fertilizers sighted constructed within the base camp area at CPT07. Agrochemicals and fertilizers sighted arranged in proper order and labelled accordingly. Mini generator-set stored under the roof and complete with bund wall. 	30 to 34	-

AEC No.	Approved Environmental Conditions (AEC)	Status	Observation / Comment	Photo No.	Corrective Action & Date of Completion
			<ul style="list-style-type: none"> ▪ Newly constructed generator-set shed sighted equipped with oil sump / trap. ▪ New storage for oil and scheduled wastes is equipped with oil trap 		
iii	<p><i>Kawasan penyimpanan bahan minyak dan sisa toksik tersebut hendaklah terlindung dari hujan dan terletak tidak kurang 50 meter pada jarak mendatar dari tebing sungai atau alur air.</i></p>	Comply	<ul style="list-style-type: none"> ▪ A generator-set shed sighted in place located more than 50m away from the nearest natural waterways. ▪ Storage shed for the agro-chemicals and fertilizers sighted sheltered. ▪ Supply of oil and lubricants sighted kept under the shed within the base camp at CPT07. ▪ These sheds are located more than 50m away from nearest natural waterways. ▪ Refer to comments in AEC No. 5.4 (ii) on mini gen-set. 	30 to 34	-
iv	<p><i>Kawasan penyimpanan bahan minyak dan sisa toksik hendaklah disediakan dengan sistem saluran serta perangkap minyak.</i></p>	Comply	<ul style="list-style-type: none"> ▪ Shed for the generator set sighted equipped with bunding and oil sump. ▪ The new scheduled waste storage area sighted equipped with an oil trap. ▪ Oil and lubricants supplies utilised in minimal amount, as and when required. 	32, 34	-
v	<p><i>Bahan minyak dan sisa toksik tersebut hendaklah dilupuskan mengikut keperluan Peraturan-</i></p>	Comply	Disposal of scheduled waste will be carried out by a DOE licensed service provider.	-	-

AEC No.	Approved Environmental Conditions (AEC)	Status	Observation / Comment	Photo No.	Corrective Action & Date of Completion
	<i>peraturan Kualiti Alam Sekeliling (Buangan Terjadual) 2005.</i>				
5.5	<u>Kawalan Sisa Pepejal dan Biomas</u>				
<i>i</i>	<i>Sebarang aktiviti pelupusan bahan sisa pepejal dan sisa biomas tidak dibenarkan dalam sungai atau alur air.</i>	Comply	Disposal of solid waste or biomass into natural waterways was not sighted during the site visit.	-	-
<i>ii</i>	<i>Kemudahan mengumpul dan mengutip sisa pepejal dan biomas hendaklah disediakan. Lokasi kawasan pengumpulan hendaklah terletak di luar kawasan simpanan sungai yang dinyatakan pada syarat 5.2(i) dalam Perjanjian Syarat-syarat Alam Sekitar ini.</i>	Comply	<ul style="list-style-type: none"> ▪ Garbage bins sighted in place at the workers' canteen and the new storage areas. ▪ Project Proponent has yet to construct a proper solid waste collection area to cater for future larger volume. ▪ No solid waste collection area within riparian reserve as sighted during the visit. 	35	-
<i>iii</i>	<i>Semua sisa pepejal seperti botol, tin, plastik dan besi hendaklah dikumpul secara berasingan dan dikitar semula.</i>	Comply	<ul style="list-style-type: none"> ▪ Temporary recyclable wastes collection spot in place near the workers' camp at CPT07. ▪ Refer to comments in AEC No. 5.5 (ii). 	36	-
<i>iv</i>	<i>Sekiranya tiada kawasan pelupusan yang sesuai dalam kawasan projek, sisa pepejal dan biomas hendaklah dilupuskan di kawasan yang diluluskan oleh pihak berkuasa tempatan yang berkaitan.</i>	Comply	At this early development phase of the ITP project, minimal solid waste produced is disposed to the nearest waste collection centre outside of the project site.	-	
5.6	<u>Kawalan Sisa Kumbahan</u>				
<i>i</i>	<i>Kemudahan sistem sanitasi dan sistem perawatan kumbahan hendaklah disediakan di kawasan</i>	Comply	Toilets located near the workers' camp equipped with septic tanks.	37-38	-

AEC No.	Approved Environmental Conditions (AEC)	Status	Observation / Comment	Photo No.	Corrective Action & Date of Completion
	projek.				
ii	Sebarang pelepasan atau pelupusan terus sisa kumbahan tidak dibenarkan dalam sungai atau alur air.	Comply	Disposal of sewage material into natural waterways was not sighted during the site visit.	-	-
iii	Sebarang effluen kumbahan yang dihasilkan hendaklah mematuhi sekurang-kurangnya Piawai B, Peraturan-Peraturan Kualiti Alam Sekeliling (Kumbahan) 2009.	Not Applicable	Sewage Treatment Plant - none constructed within project site.	-	
5.7	<u>Kawalan Kualiti Udara Dan Kebakaran</u>				
i	Pembakaran terbuka adalah tidak dibenarkan.	Comply	<ul style="list-style-type: none"> ▪ Open burning was not sighted during the site visit. ▪ Signage on prohibition of open burning sighted in place. 	39, 40	-
ii	Pelan Pengurusan Pencegahan Kebakaran Hutan kawasan projek yang telah diperakui oleh Jabatan Perhutanan Negen Sabah hendaklah dilaksanakan dan sesalinan pelan tersebut dikemukakan ke JPAS.	Comply	According to the Project Proponent, the Forest Fire Prevention and Management Plan had been previously submitted to the EPD.	-	-
5.8	<u>Penghentian Atau Penamatan Projek</u>				
i	Semua struktur binaan yang tidak digunakan hendaklah dibuka secara teratur apabila berlaku penghentian atau penamatan projek tersebut.	Not Applicable	Not applicable at the current stage of development.	-	-
ii	Semua tanah yang tercemar dengan bahan minyak dan bahan berbahaya hendaklah dikeluarkan dan dibersihkan.	Not Applicable	Refer to the comment in AEC No. 5.8 (i).	-	-
iii	Semua kawasan yang terdedah hendaklah dilindungi dengan	Not	Refer to the comment in AEC No.		



AEC No.	Approved Environmental Conditions (AEC)	Status	Observation / Comment	Photo No.	Corrective Action & Date of Completion
	<i>menanam spesies tumbuhan yang diluluskan oleh Jabatan Perhutanan Negeri Sabah.</i>	Applicable	5.8 (i).		
iv	<i>Semua kawasan cerun hendaklah distabilkan.</i>	Not Applicable	Refer to the comment in AEC No. 5.8 (i).		
v	<i>Satu Laporan Pematuhan Alam Sekitar dengan format dan kandungan laporan sebagaimana dinyatakan dalam Garis panduan Penyediaan Laporan Pematuhan Alam Sekitar, Keluaran Jun 2018 hendaklah dikemukakan sekiranya berlaku penghentian atau penamatan projek.</i>	Not Applicable	Refer to the comment in AEC No. 5.8 (i).		

6.0 CONCLUSION

6.1 Overall Compliance for March – June 2023

The Project (Proposed Salvage Logging and Industrial Tree Plantation (ITP) [11,191 hectares] within Paitan Forest Reserve under Forest Management Unit (FMU) No. 2, Labuk Sugut, Beluran District, Sabah), generally complied with the AEC approval conditions, without non-compliances.

PERAKUAN PAS

Dengan ini saya mengaku telah turut serta dalam odit yang dijalankan oleh perunding alam sekitar dan telah meneliti dan bersetuju dengan isi kandungan Laporan Pematuhan Alam Sekitar bagi projek ini.

Tandatangan : 
Nama : THONIK VENANTIUS
Jawatan : PROJECTS DIRECTOR
Tarikh : 08.08.2023
Cop Rasmi syarikat :



PERAKUAN PERUNDING ALAM SEKITAR

Dengan ini saya mengaku dan mengesahkan semua kenyataan dan butir-butir dalam Laporan Pematuhan Alam Sekitar yang dikemukakan adalah benar.

Tandatangan : 
Nama : Jessica Malagkas
Tarikh : 8. Aug. 2023
Cop Rasmi syarikat :



APPENDIX B

Environmental Monitoring Report



1.0 SURFACE WATER MONITORING

1.1 MONITORING LOCATION

Surface water sampling was scheduled to be carried out on the 26th June 2023 at six (6) monitoring locations, **W1** to **W6** as shown **Figure 2.0**.

However, no water sampling was conducted at locations **W1** – **W5** as Project development had yet to progress in areas affecting said monitoring locations, whilst monitoring location **W6** was stagnant during the visit.

1.2 SURFACE WATER

Surface water quality monitoring was designed to determine the chemical and physical characteristics of water at the designated monitoring location shown in **Figure 2.0**. Water samples were collected, preserved and transported to the lab for analysis.

Parameters of interest includes Turbidity, Total Suspended Solids (TSS), Oil & Grease (O&G) and Total Coliform Count (TCC). Analytical methodologies for these parameters are summarised in **Table 5.0**.

Table 5.0: Analytical methodologies

Parameter	Method Reference
Turbidity	APHA 2130 B, 2017
Total Suspended Solids (TSS)	APHA 2540 D, 2017
Oil & Grease	APHA 5520 B, 2017
Total Coliform Count (TCC)	APHA 9221 B, 2017

1.3 RESULTS

Surface water quality results will be compared against **Class IIB** of **National Water Quality Standards for Malaysia (NWQSM)**; however no sample was available during this audit.

Chart 1.0 to **Chart 4.0** present the historical water quality results for location **W6**.

1.4 RECOMMENDED MITIGATION MEASURES

- Development or clearing within conservation areas, i.e. buffer zones, riparian reserves and slopes with 25° or more, should not be conducted.
- Vegetation clearing should be carried out in stages and confined to areas that are relevant for Project development, whereby salvage logging also is recommended to be conducted as per schedule.
- Planting of the final crop should be carried soon after the clearing of planting areas to avoid prolonged of bare ground exposure to rain (i.e. soil erosion), whereby clearing done during dry season and planting during rainy season.
- Less soil-surface-damaging machinery should be used for site clearing instead of bulldozers, such as excavators.
- Reduced Impact Logging (RIL) method as per required by Sabah Forestry Department (SFD) should be implemented.
- Proper culverts or bridges should be in place for stream crossing area, which blocking of water stream should be avoided.

HISTORICAL WATER QUALITY RESULTS

Chart 1.0: Turbidity Level vs Monitoring Location

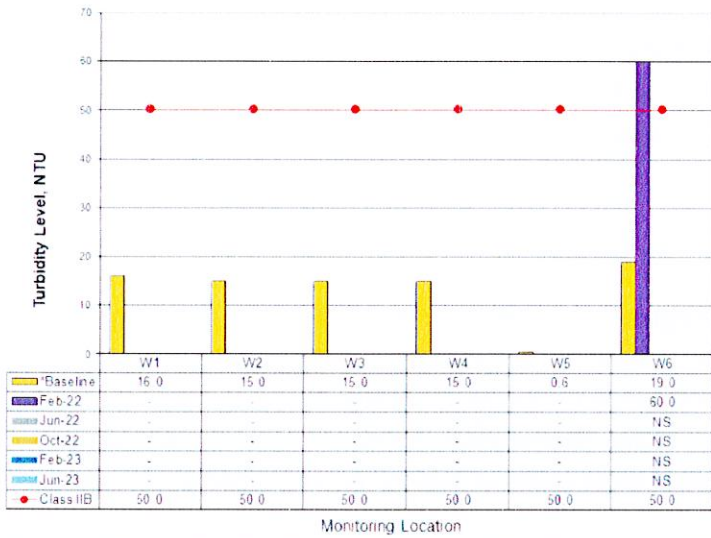

Chart 2.0: Total Suspended Solid (TSS) vs Monitoring Location

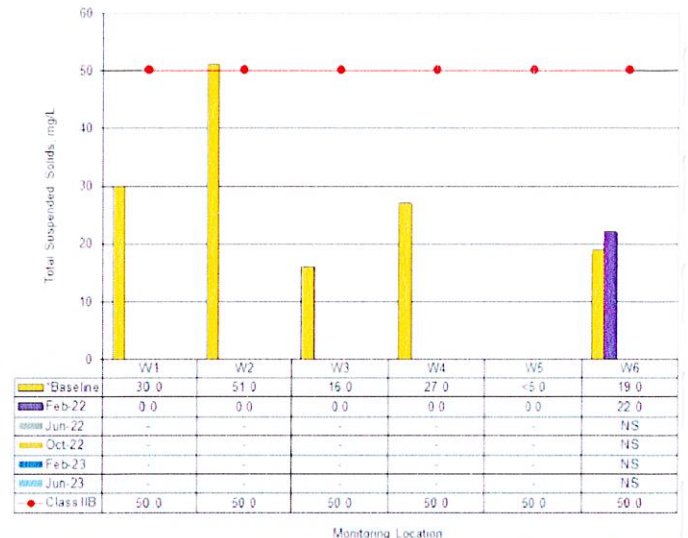

Chart 3.0: Oil & Grease (O&G) vs Monitoring Location

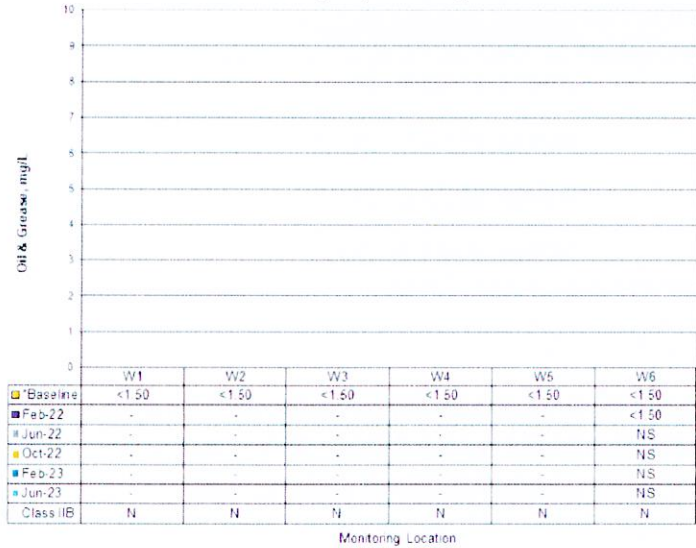
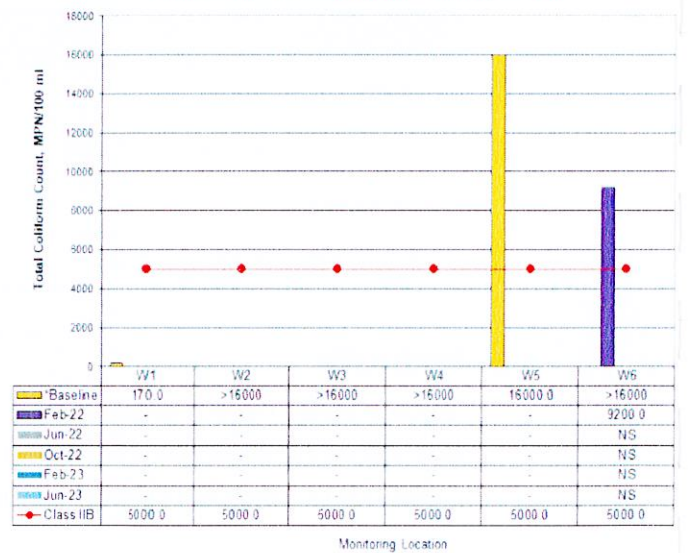

Chart 4.0: Total Coliform Count (TCC) vs Monitoring Location



Notes:

* Baseline data adapted from EIA for Proposed Salvage Logging and Industrial Tree Plantation (ITP) [12,123.60 ha] within Paitan Forest Reserve under Forest Management Unit (FMU) No. 2, Labuk Sugut, Beluran District, Sabah by Chemsain Konsultant Sdn. Bhd.

(<>) denotes below / above detection limit

(-) denotes No Sampling as Project Development has yet progress to this area

(NS) denotes No Available Sample

(N) denotes Free from visible sheen, discoloration and deposits



National Water Quality Standards for Malaysia
(NWQSM)



NATIONAL WATER QUALITY STANDARDS FOR MALAYSIA

Parameter	Classes						
	Unit	I	IIA	IIB	III	IV	V
Ammoniacal-N.	mg/l	0.1	0.3	0.3	0.9	2.7	>2.7
BOD	mg/l	1	3	3	6	12	>12
COD	mg/l	10	25	25	50	100	>100
DO	mg/l	7.0	5.0 – 7.0	5.0 – 7.0	3.0 – 5.0	<3.0	<1.0
pH		6.5 – 8.5	6.0 – 9.0	6.0 – 9.0	5.0 – 9.0	5.0 – 9.0	-
Colour	TCU	15	150	150	-	-	-
Elec. Cond*	µS/cm	1000	1000	-	-	6000	-
Floatables		N	N	N	-	-	-
Odour		N	N	N	-	-	-
Salinity*	%	0.5	1	-	-	2	-
Taste		N	N	N	-	-	-
Tot. Diss. Sol.*	mg/l	500	1000	-	-	4000	-
Tot. Susp. Sol.	mg/l	25	50	50	150	300	>300
Temperature	°C	-	Normal±2	-	Normal±2	-	-
Turbidity	NTU	5	50	50	-	-	-
F. Coliform**	counts/100ml	10	100	400	5000 (20000) ^a	5000 (20000) ^a	-
Total Coliform	counts/100ml	100	5000	5000	50000	50000	>50000

N = No visible floatable material / debris; or no objectionable odour; or no objectionable taste.

* = Related parameters, only one recommended for use

** = Geometric mean

± = Maximum not to be exceeded

CLASS USES

- I represent water body of excellent quality. Standards are set for the conservation of natural environment in its undisturbed state. Water bodies such as those in the national park areas, fountainheads, and in high land and undisturbed areas come under this category where strictly no discharge of any kind is permitted. Water bodies in this category meet the most stringent requirements for human health and aquatic life protection.
- IIA / IIB represents water bodies of good quality. Most existing raw water supply sources come under this category. In practice, no body contact activity is allowed in this water for prevention of probable human pathogens. There is a need to introduce another class for water bodies not used for water supply but of similar quality which may be referred to as **Class IIB**. The determination of **Class IIB** standard is based on criteria for recreational use and protection of sensitive aquatic species.
- III is defined with the primary objective of protecting common and moderately tolerant aquatic species of economic value. Water under this classification may be used for water supply with extensive / advance treatment. This class of water is also defined to suit livestock drinking needs.
- IV defines water quality required for major agricultural irrigation activities which may not cover minor applications to sensitive crops.
- V represents other waters which do not meet any of the above uses.